

VIEW

SPAZIO ALLA LUCE

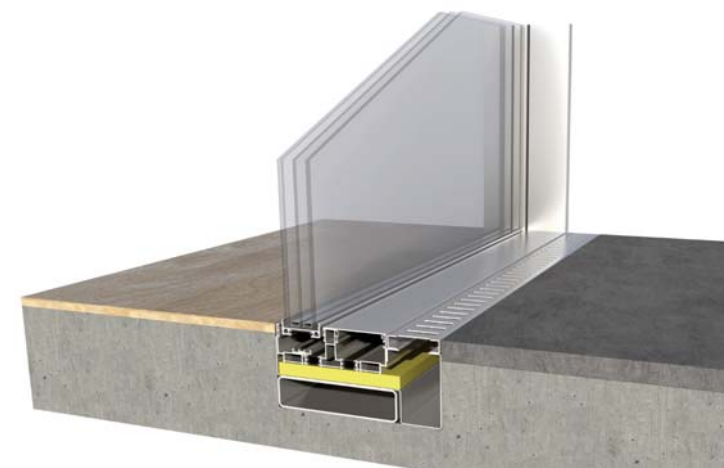

La riduzione di ostacoli visibili garantisce ambienti più luminosi, senza influire sulle prestazioni di efficienza energetica e sul comfort climatico.



Grazie alle grandi dimensioni raggiungibili dalle ante apribili (2,5m/L - 4m/H) unite alle parti fisse, permettono di realizzare intere pareti vetrate (inclusi angoli) a luminosità e vista panoramica totale.

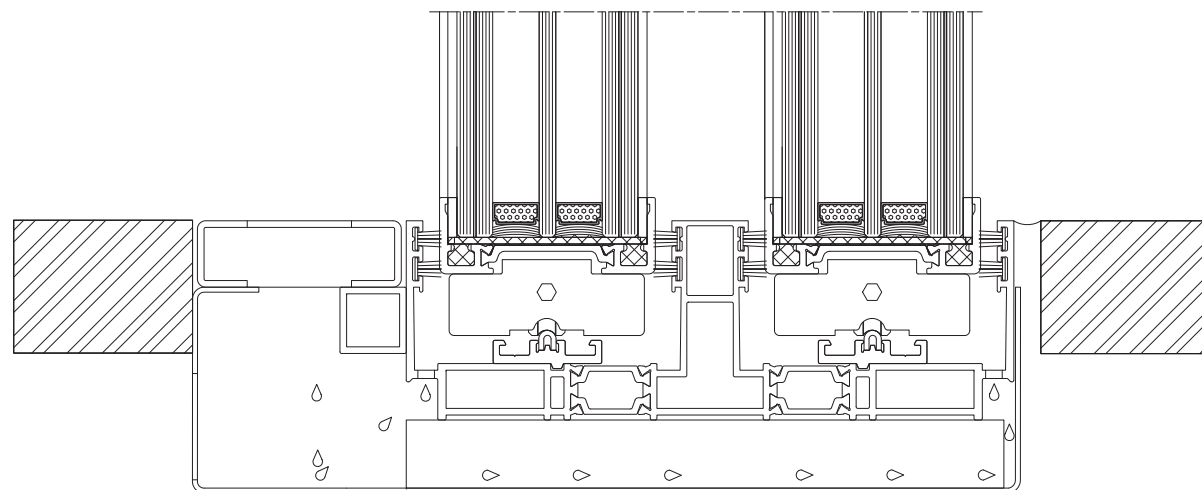

Dati tecnici (testati su campione 3400x3600mm)



PESO MAX ANTA
500KG

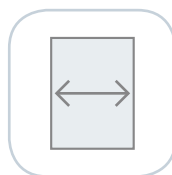

LARGHEZZA MAX ANTA
2500MM

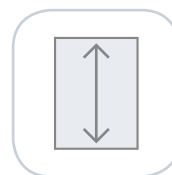

ALTEZZA MAX ANTA
4000MM

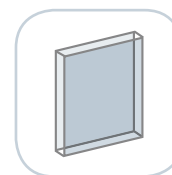

SPESSORE MAX VETRO
54MM



TRASMITTANZA TERMICA
1,1-1,5 W/M²K



PERMEABILITÀ ALL'ARIA
CLASSE 4



TENUTA ALL'ACQUA
CLASSE 8A



RESISTENZA
AL CARICO DEL VENTO
CLASSE C2 / CLASSE B3

Soluzioni Possibili

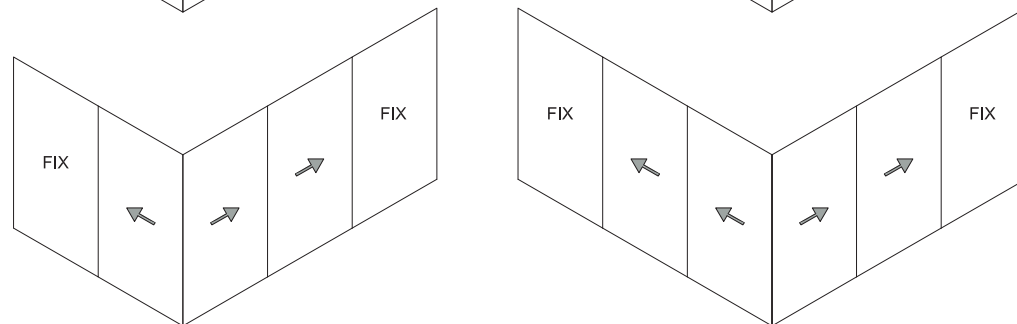
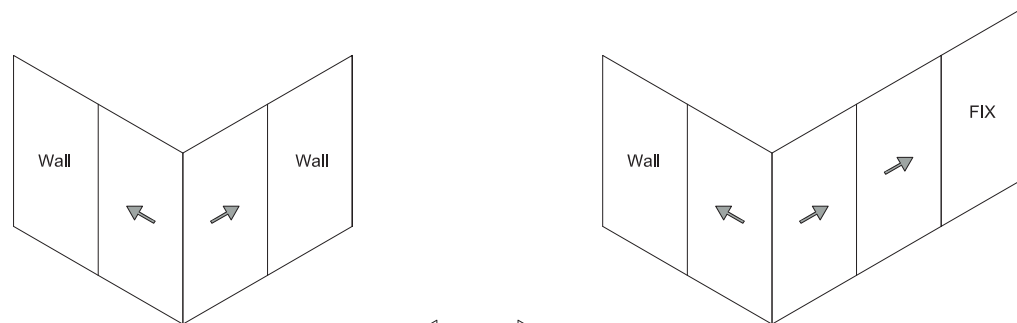
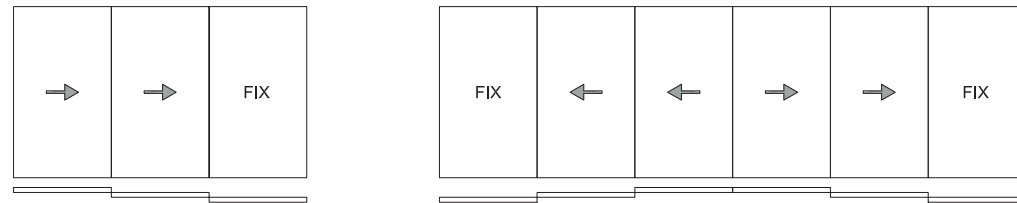
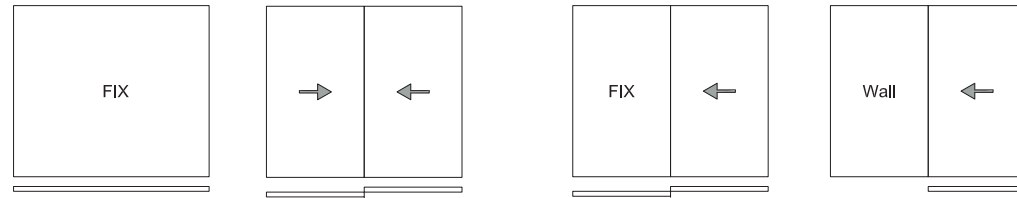

Soluzioni lato inferiore ante

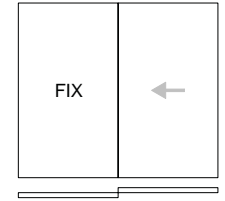

Soluzione standard

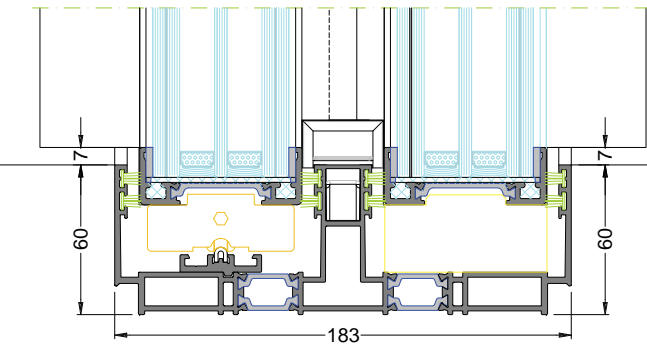

Vista anta 7mm per tutti i lati

Soluzione con copri rotaia

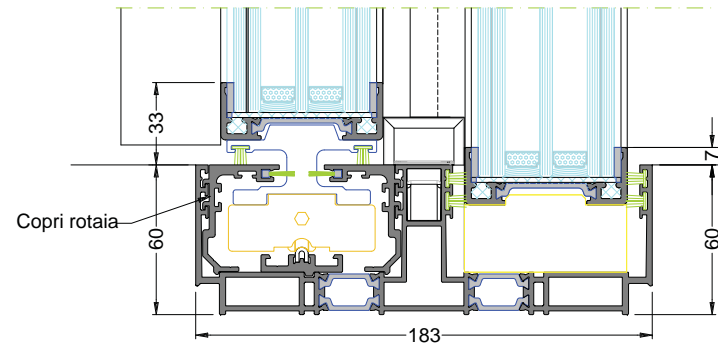

Vista anta apribile inferiore 33mm
Vista anta laterali e superiore 7mm
Vista anta fissa vista 7mm con copribinario

Soluzione con copri rotaia anta fissa rialzata

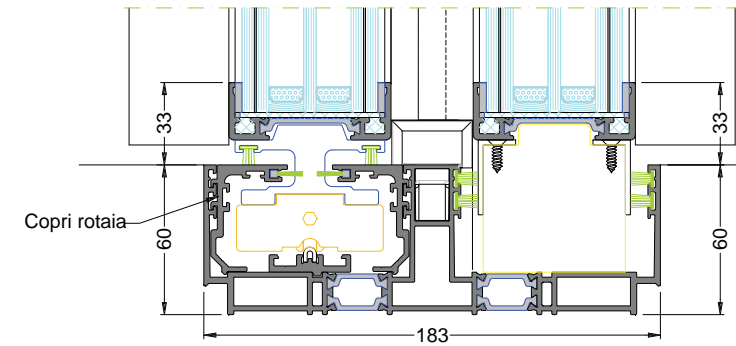

Vista anta inferiore apribile e fissa 33mm
Vista anta laterali e superiore 7mm con fissa stessa altezza anta apribile

Soluzione 1 anta a scomparsa



GASTALDELLO SISTEMI

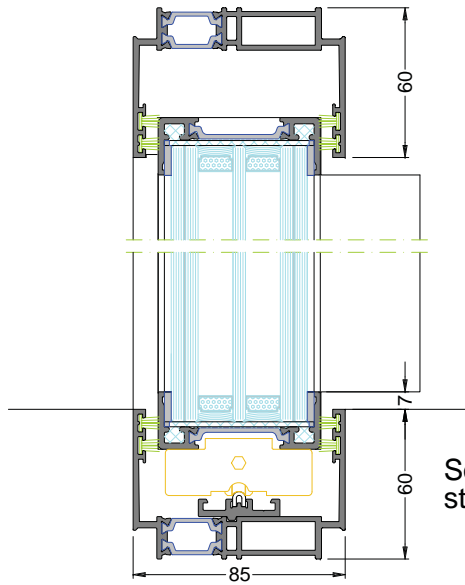
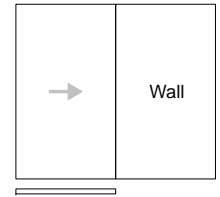

Soluzione standard

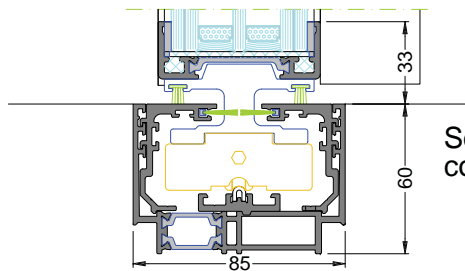
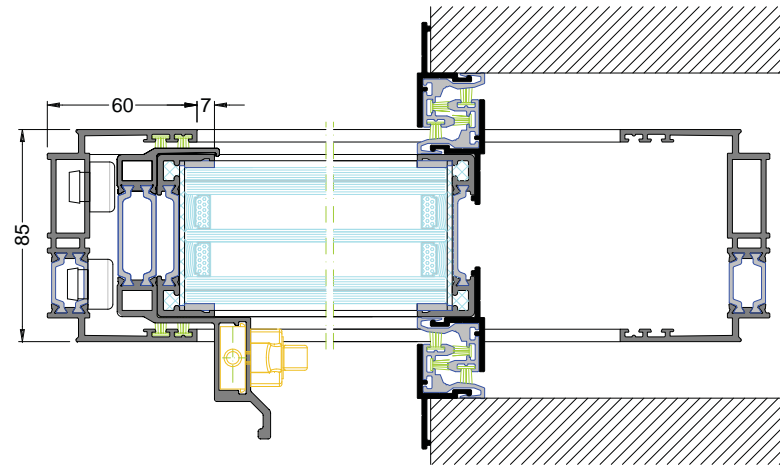

Soluzione con copri rotaia

Soluzione angolo

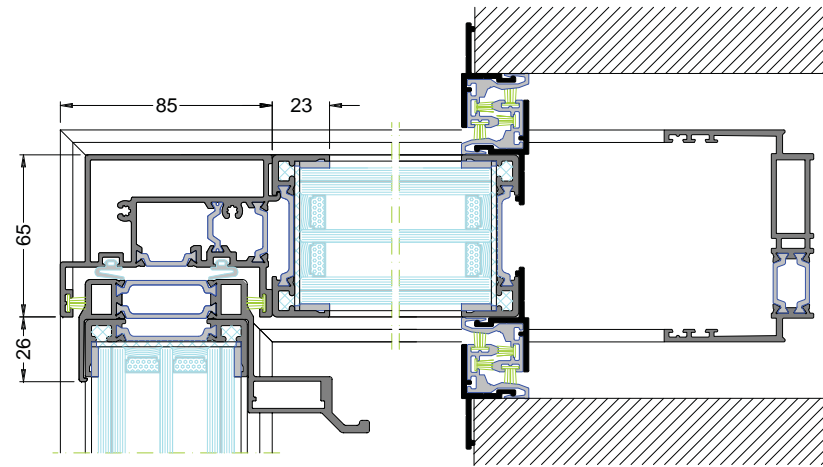
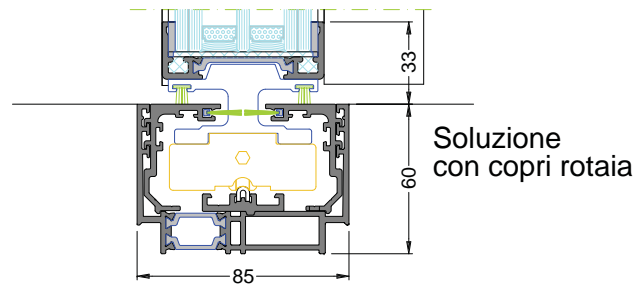
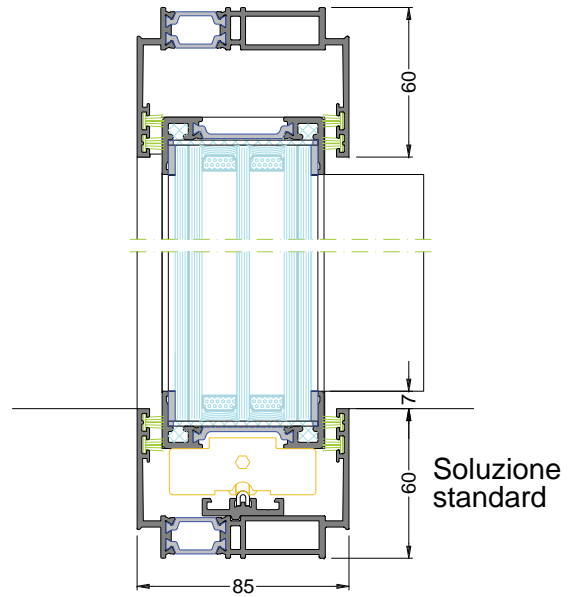
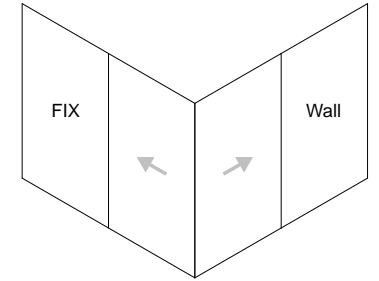

Soluzione 2 ante



GASTALDELLO SISTEMI

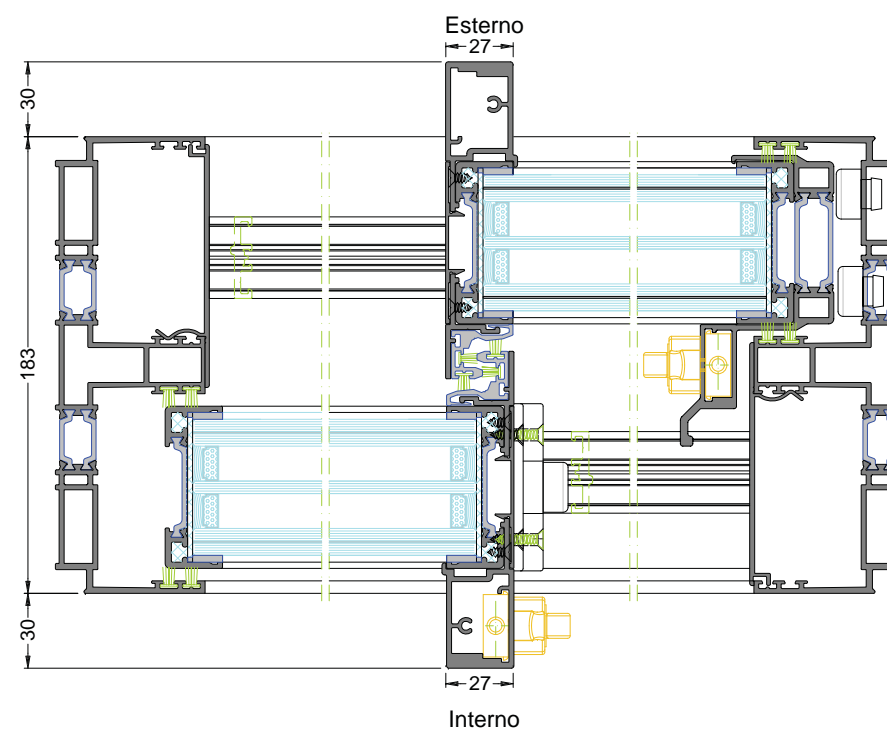
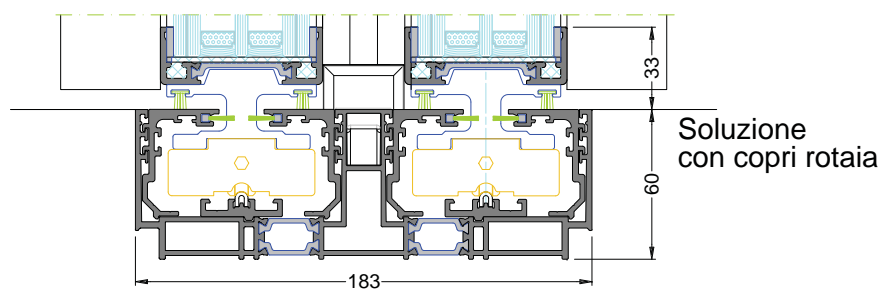
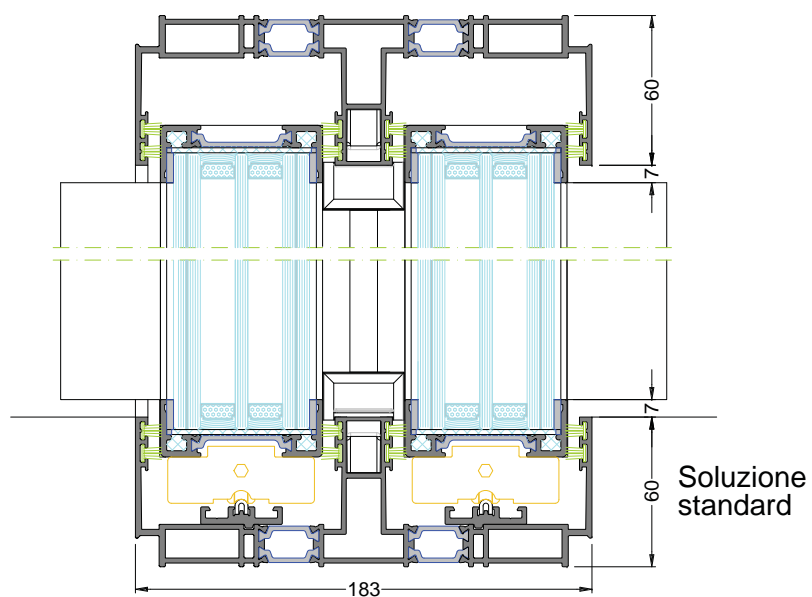
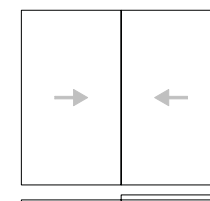

Soluzione 2 ante con fisso

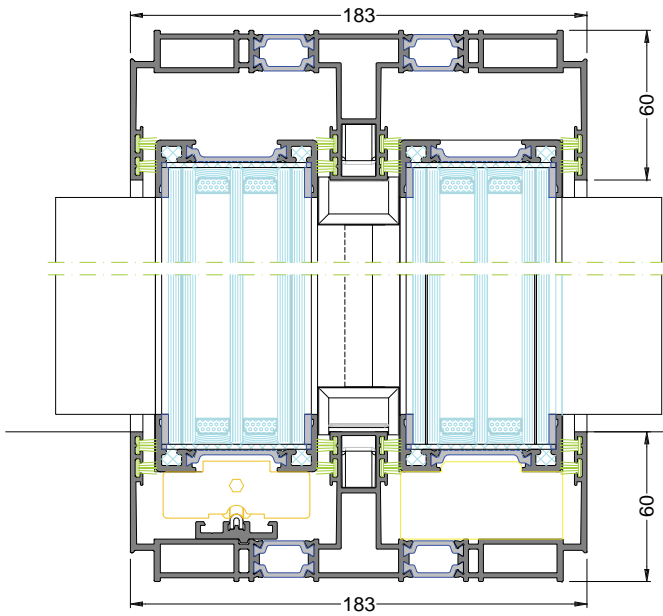

Soluzione standard

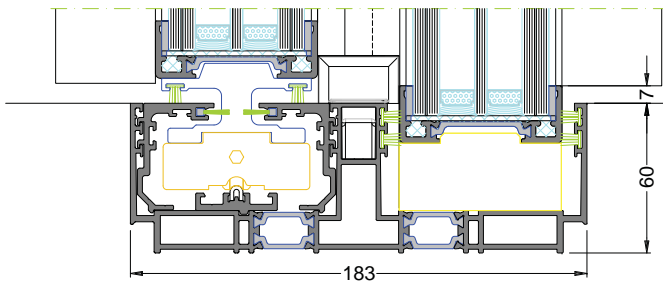

Soluzione con copri rotaia

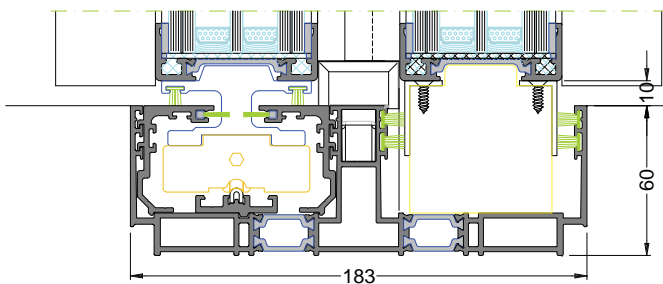

Soluzione con copri rotaia anta fissa rialzata

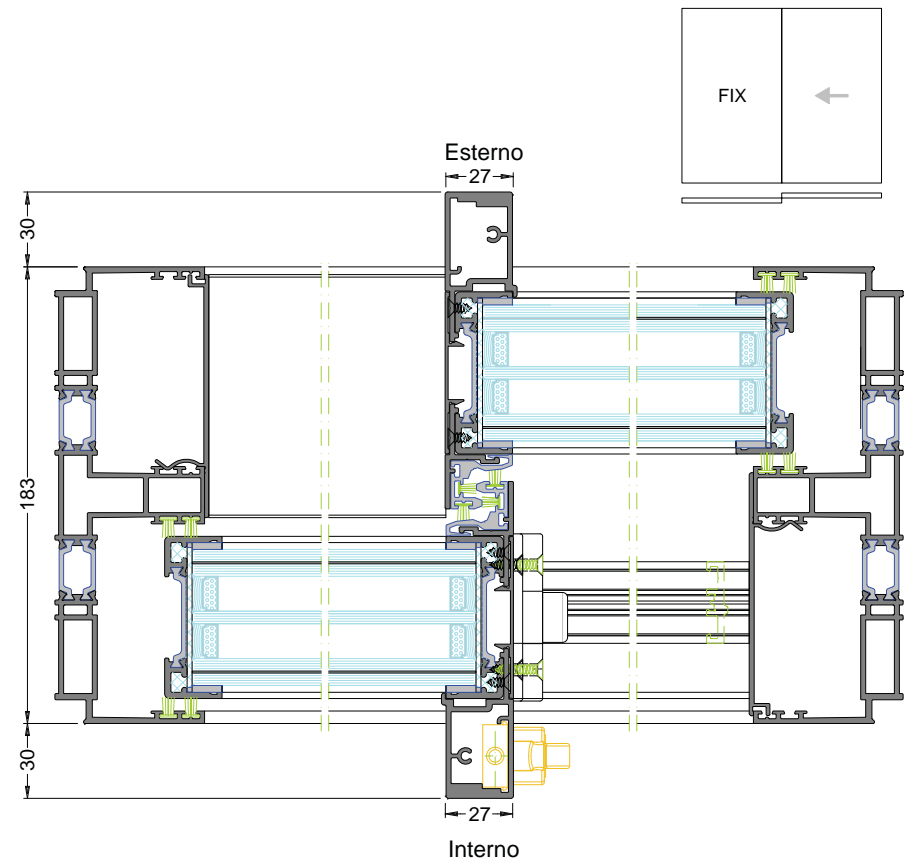

Soluzione 4 ante con fissi

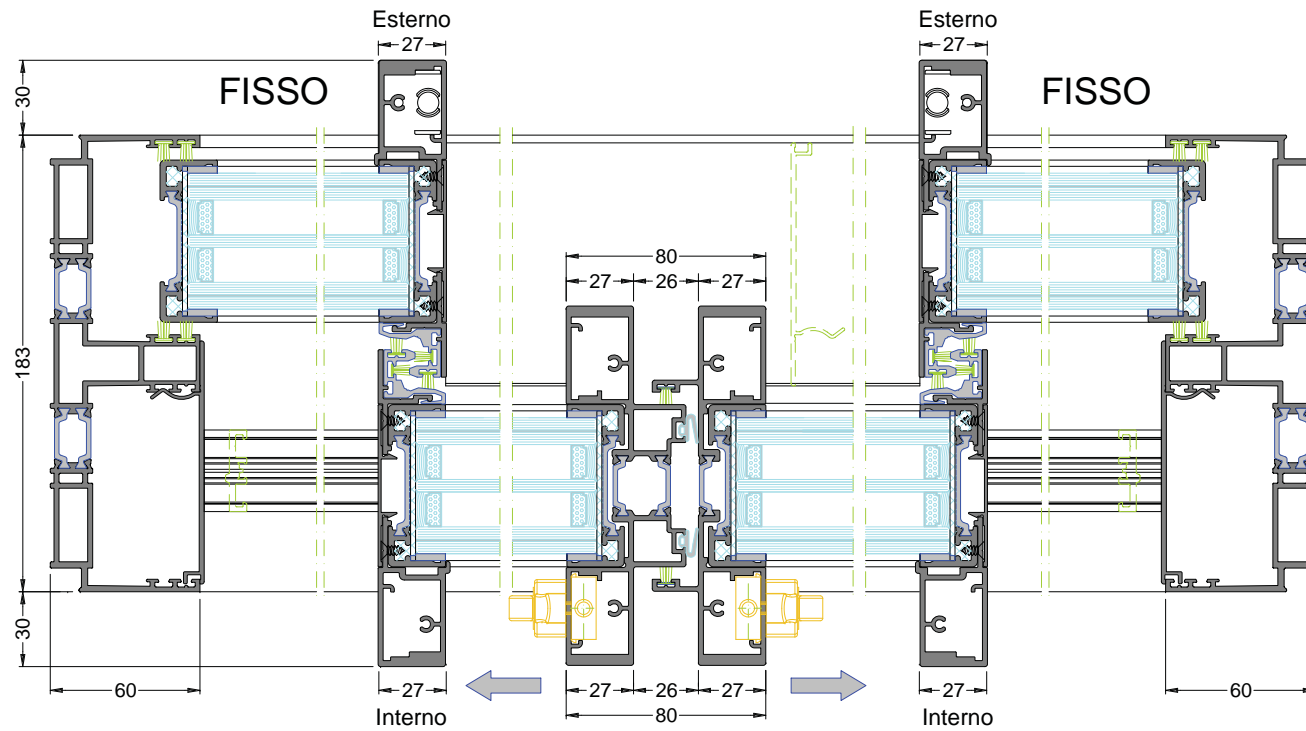
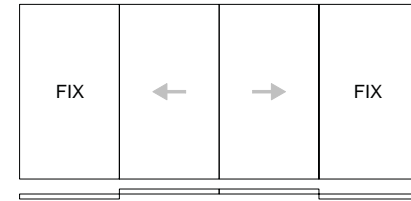

Soluzione 3 ante con fisso



GASTALDELLO SISTEMI

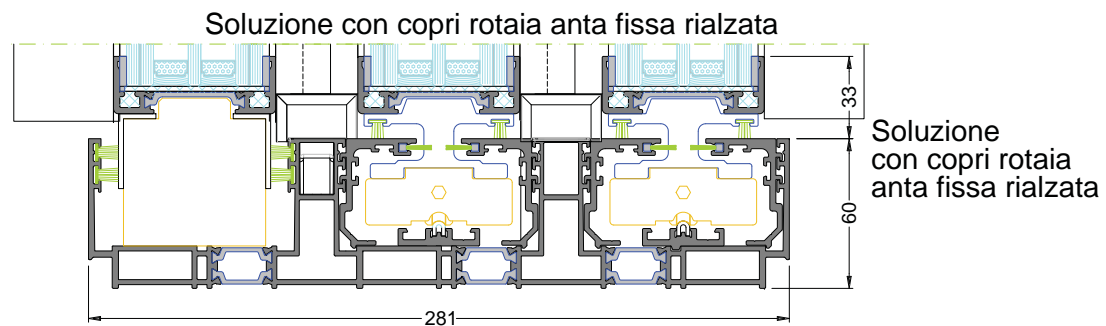
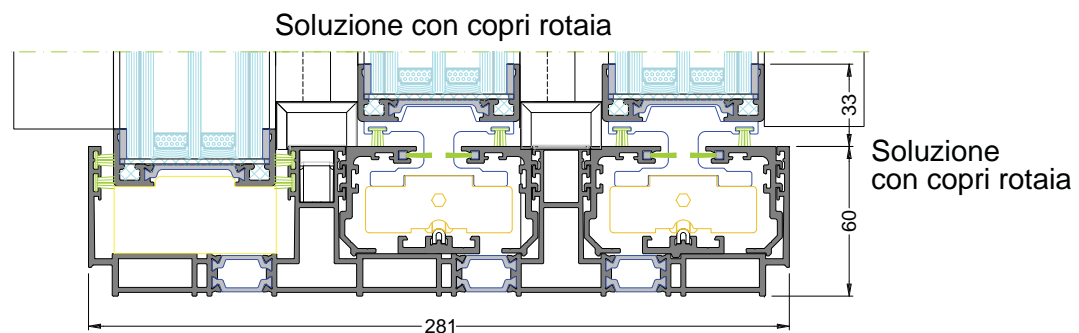
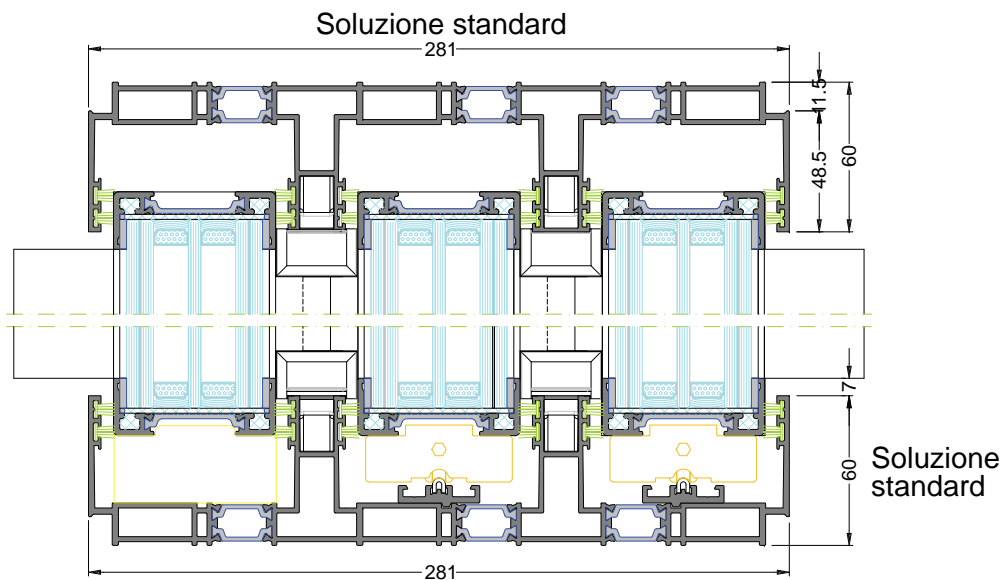
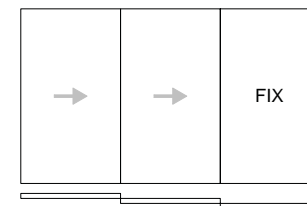

Varianti angolo 90°

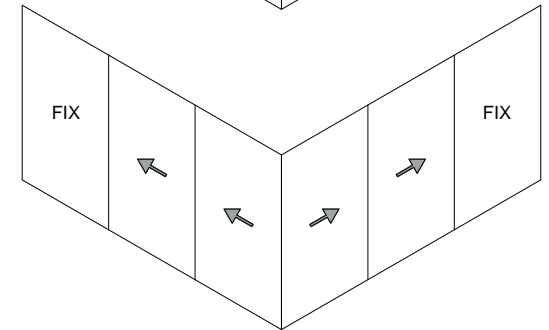
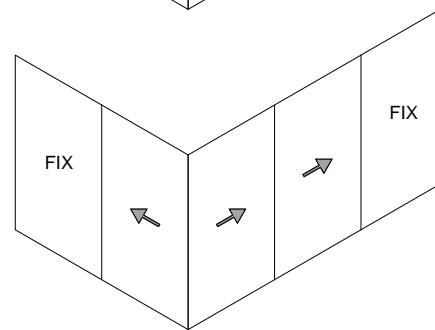
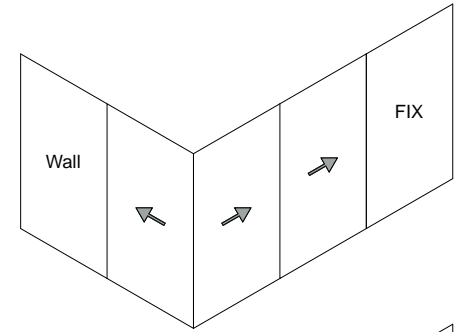
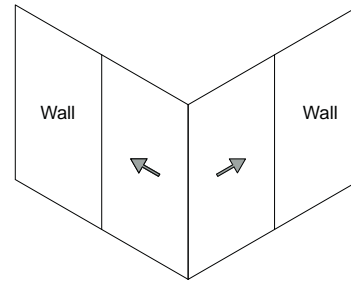
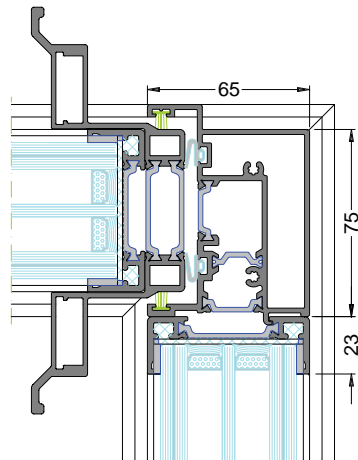
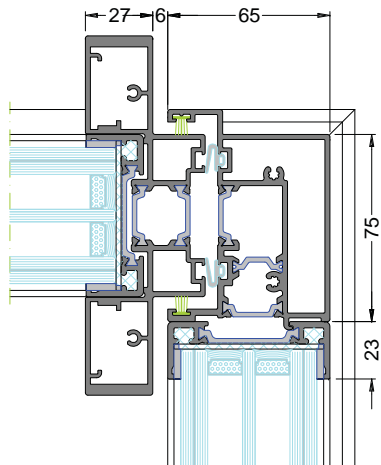
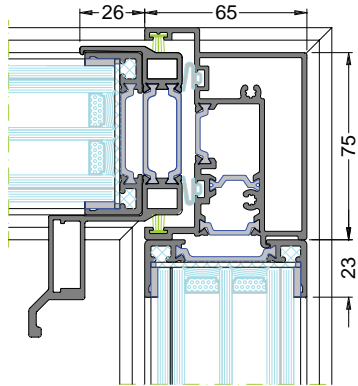

Varianti riporti centrali

Con rinforzo interno ed esterno

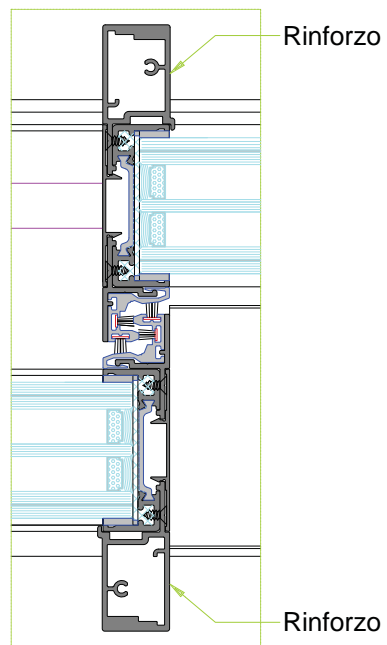

Con rinforzo solo interno

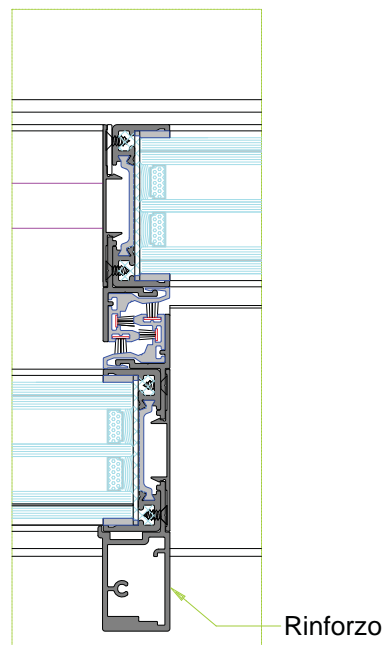

Senza rinforzo

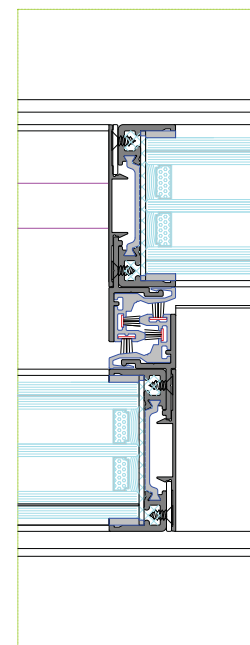

Specifiche vetro

LUCHE		ENERGIA	
Trasmissione	73	Fattore solare	48
Riflessione	18	Riflessione	34

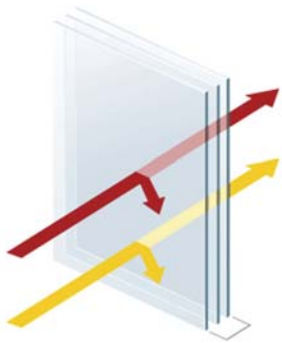

CARATTERISTICHE LUMINOSE (EN 410)	EN 410
Trasmissione luminosa - tv (%)	73
Riflessione luminosa - pv (%)	18
Indice di resa dei colori - RD65 - Ra (%)	97

CARATTERISTICHE ENERGETICHE	EN 410	ISO 9050
Fattore solare - g (%)	48	45
Riflessione energetica - pe (%)	34	35
Trasmissione energetica diretta - te (%)	43	41
Assorb. energetico vetro 1 - ae (%)	18	20
Assorb. energetico vetro 2 - ae (%)	1	1
Assorb. energetico vetro 3 - ae (%)	5	4
Assorbimento energetico - ae (%)	24	25
Coefficiente di shading - SC	0.55	0.52
Trasmissione dei raggi ultravioletti - UV (%)	0	
Selettività	1.52	1.62

PROPRIETÀ TERMICHE (EN 673)	EN 673
Valore Ug - W/(m².K)	0.6

ALTRE CARATTERISTICHE		
Resistenza al fuoco - EN 13501-2		NPD
Reazione al fuoco - EN 13501-1		NPD
Resistenza ai proiettili - EN 1063		NPD
Resistenza agli attacchi manuali - EN 356		NPD
Resistenza agli urti (Prova del pendolo) - EN 12600	1B1 / NPD / 12600	1B1

RIDUZIONE ACUSTICA		
Isolamento al rumore aereo diretto - dB		42 (-2, -7)

SPESSORE E PESO		
Spessore nominale (mm)		53.76
Peso (kg/m²)		64

COMPOSIZIONE VETRO

- Vetro extrachiario
- Canalina calda (warm edge)
- Gas Argon 90% watt ADG 8
- PVB 0,76

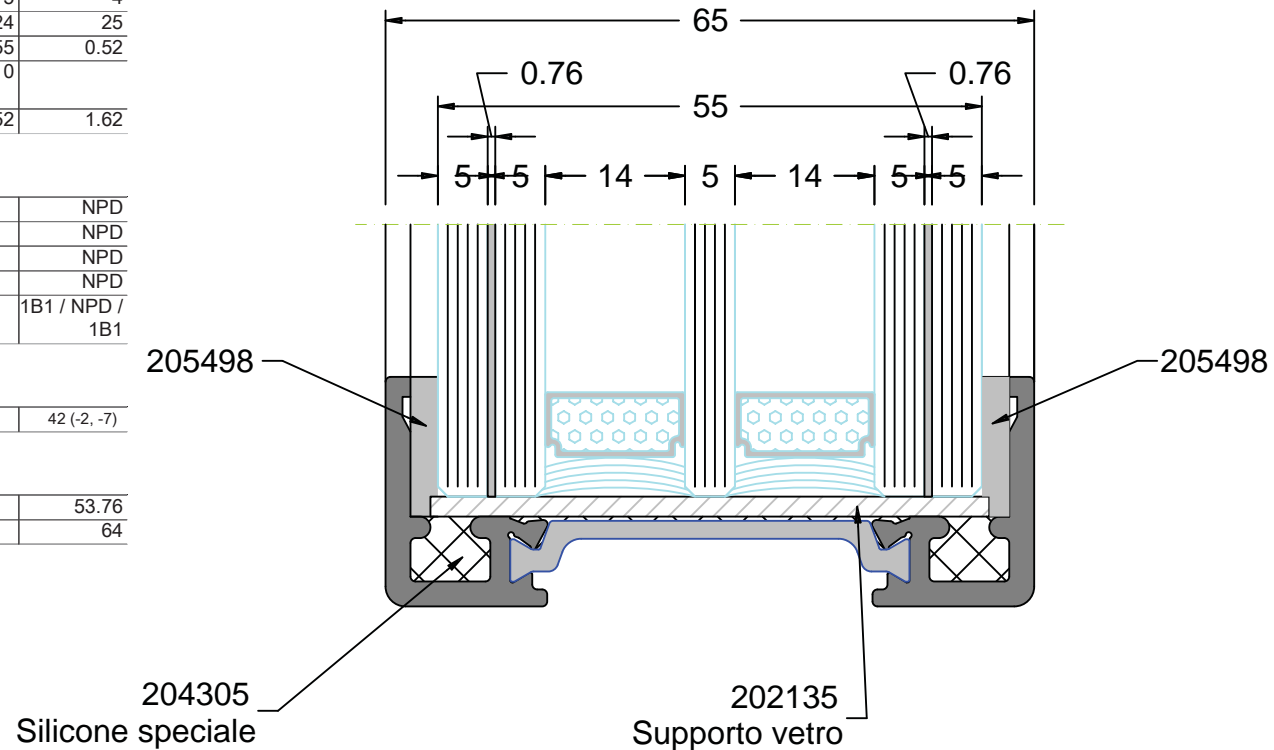

Punti di forza sistema

- Telaio a scomparsa
- Anta in vista 7mm
- Montaggio telai a 45° per montaggio senza pavimento
- Montaggio telai a 90° per montaggio con pavimento
- Possibilità di regolazioni carrelli
- Possibilità di sostituzioni spazzolini

Tipologie realizzabili

Il sistema consente la realizzazione di pareti vetrate con ante fisse e scorrevoli con telai a scomparsa a 1-2-3 vie con 2 3 4 6 ante fisse e mobili e soluzioni con angolo 90°.

Dimensioni

- Larghezza rotaia singola via 85 mm
- Larghezza rotaia 2 vie 183 mm
- Larghezza rotaia 3 vie 281 mm
- Larchezza anta 65 mm.

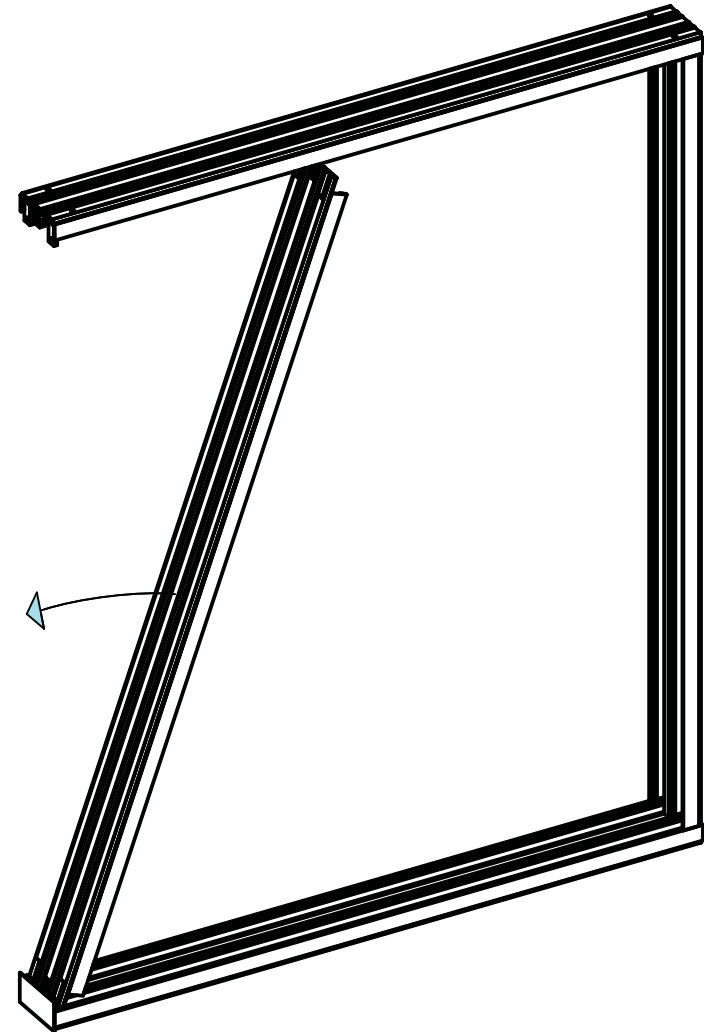

Lavorazione esportazioni dentini per inserimento spazzolino

Da fare nelle larghezze per soluzione standard.
Solo larghezza superiore per soluzione anta con copri rotaia

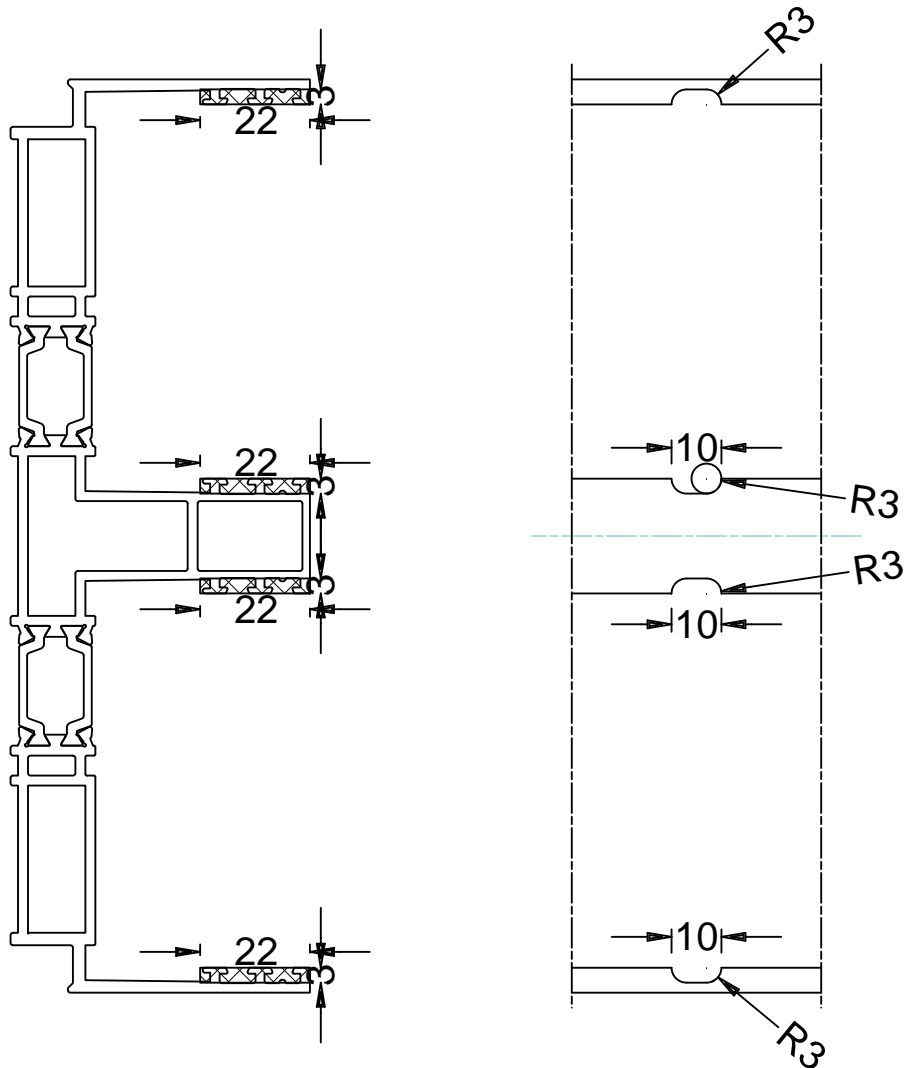

Foto

Maniglia



Montaggio 90°



2 Ante



4 Ante

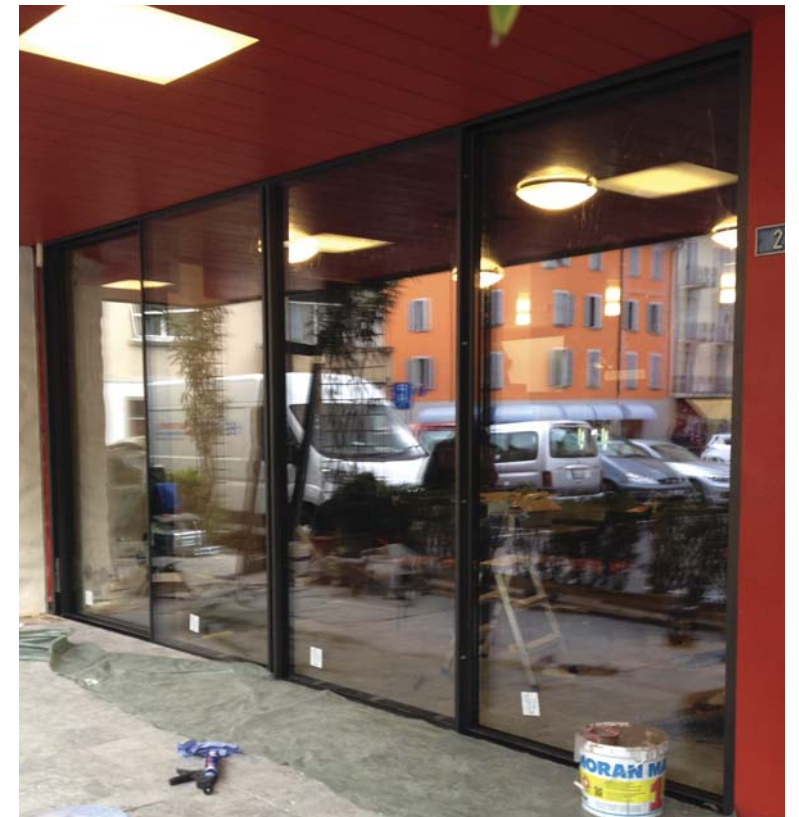

VIEW

SPAZIO ALLA LUCE



La serie VIEW la nuova linea di scorrevoli adatta alla creazione di spazi luce ampi e suggestivi.